

# Compass I420 Safety Recall Instructions

- 1- Verify that your Compass I420 is in the affected recall dates of 05/07/06 to 05/15/06. The Date of Manufacturer is date stamped on the label shown in the drawing.

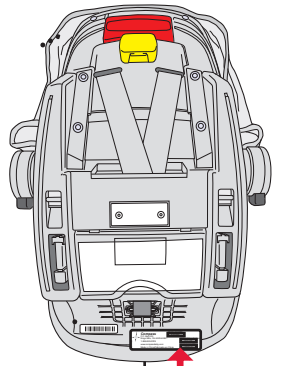

- 2- If your Date of Manufacturer is from the affected dates of 05/07/06 to 05/15/06 Locate the yellow crotch anchor as shown in the balloon drawing to the right.



Date Stamp

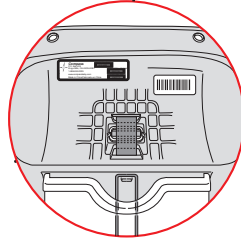

- 3- Loosen the harness adjuster and move the webbing to the side. If the yellow crotch anchor matches the picture your I 420 is not affected.

correct

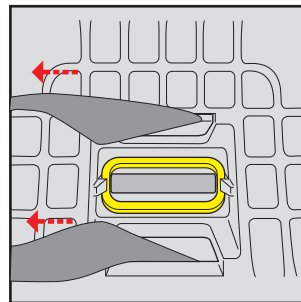

- 4- If your yellow crotch anchor doesn't match the drawing proceed to Step 5.

# I420 Incorrect Positioning Correction.

- 5- The incorrect position of the yellow crotch anchor will look like the drawing to the right.

incorrect

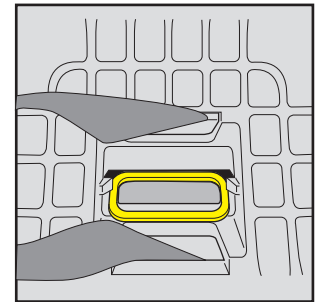

- 6- If the crotch anchor matches the image in Step 5 insert a flat edge screw driver as shown in the drawing. After inserting screw driver pry up on the crotch anchor and push forward.

Note - You will feel a "pop" when the crotch anchor has cleared the opening.

screwdriver in

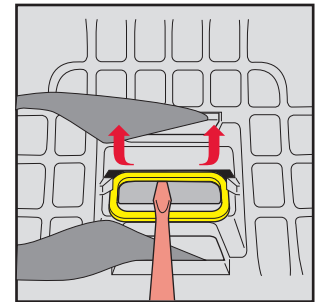

- 7- After the yellow crotch anchor has cleared the opening, push the crotch anchor forward about 1/4 inch.

Note - There will be slight movement with yellow crotch anchor after it is in the correct position.

push in place

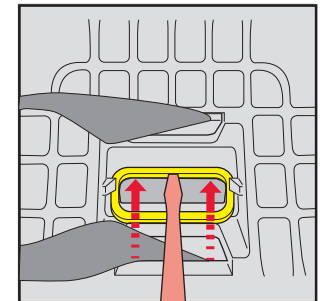

- 8- After Step 7 the crotch anchor should match the drawing to the right. If not repeat Steps 5 to 8.

If you need further assistance call Compass at 1-888-899-2229 or visit [www.compassbaby.com](http://www.compassbaby.com).

correct

